

ACCESSORIES AVAILABLE  
ACCESORIOS DISPONIBLES  
ACCESSOIRES DISPONIBLES

BC601	4 oz. Bostitch Air-Tool Lubricant
BC602	1 pint Bostitch Air-Tool Lubricant
BC603	1 pint Bostitch "Winter-Formula" Air-Tool Lubricant
BC604	1 quart Bostitch Air-Tool Lubricant
851385	Loctite Grade 242 (.02 oz.)
N80K2	Remote control kit
N89ORK	Kit, O-ring repair
171343	Shield, Dust, N89C
1134B-0864701	Plug, Dust Shield

# BOSTITCH®

## N89C

COIL-FED PNEUMATIC FRAMING NAILER  
CLAVADORA NEUMÁTICA ALIMENTADA POR ROLLO  
CLOUEUR PNEUMATIQUE À ENROULEMENT



TOOL PARTS ILLUSTRATION  
ILUSTRACIÓN DE LAS PIEZAS DE LA HERRAMIENTA  
ILLUSTRATION DES PIÈCES D'OUTILLAGE

**⚠ WARNING:**

**⚠ ADVERTENCIA:**

**⚠ ATTENTION:**

BEFORE PERFORMING REPAIRS ON THIS TOOL, ALL OPERATORS SHOULD STUDY THIS ILLUSTRATION, AS WELL AS THE PARTS LIST AND OPERATION AND MAINTENANCE MANUAL. OPERATORS SHOULD UNDERSTAND AND FOLLOW ALL SAFETY WARNINGS AND INSTRUCTIONS. KEEP THIS ILLUSTRATION WITH THE TOOL FOR FUTURE REFERENCE. IF YOU HAVE ANY QUESTIONS, CONTACT YOUR BOSTITCH REPRESENTATIVE OR DISTRIBUTOR.

ANTES DE LLEVAR A CABO CUALQUIER REPARACIÓN EN LA HERRAMIENTA, TODOS LOS OPERARIOS DEBERÁN ESTUDIAR ESTA ILUSTRACIÓN, ASÍ COMO LA LISTA DE PIEZAS Y EL MANUAL DE OPERACIÓN Y MANTENIMIENTO. LOS OPERARIOS DEBERÁN ENTENDER Y SEGUIR TODAS LAS ADVERTENCIAS E INSTRUCCIONES DE SEGURIDAD. CONSERVE ESTA ILUSTRACIÓN CON LA HERRAMIENTA PARA PODER CONSULTARLA EN LO FUTURO. SI TUVIERA ALGUNA PREGUNTA, PÓNGASE EN CONTACTO CON SU REPRESENTANTE O DISTRIBUIDOR DE BOSTITCH.

AVANT DE PROCÉDER À LA RÉPARATION DE CET OUTIL, LES OPÉRATEURS DOIVENT ÉTUDIER LA PRÉSENTE ILLUSTRATION AINSI QUE LA LISTE DE PIÈCES ET LE MANUEL D'INSTRUCTIONS ET D'ENTRETIEN ; ILS DOIVENT ÉGALEMENT COMPRENDRE ET OBSERVER LES CONSIGNES DE SÉCURITÉ ET LES INSTRUCTIONS. CONSERVER CETTE ILLUSTRATION AVEC L'OUTIL POUR RÉFÉRENCE FUTURE. SI VOUS AVEZ DES QUESTIONS, COMMUNIQUEZ AVEC VOTRE REPRÉSENTANT OU VOTRE DISTRIBUTEUR DE BOSTITCH.

IP1219-1REVD 5/06

**BOSTITCH®**  
Stanley Fastening Systems L.P.

# N89C

## COIL-FED PNEUMATIC FRAMING NAILER CLAVADORA NEUMÁTICA ALIMENTADA POR ROLLO CLOUEUR PNEUMATIQUE À ENROULEMENT

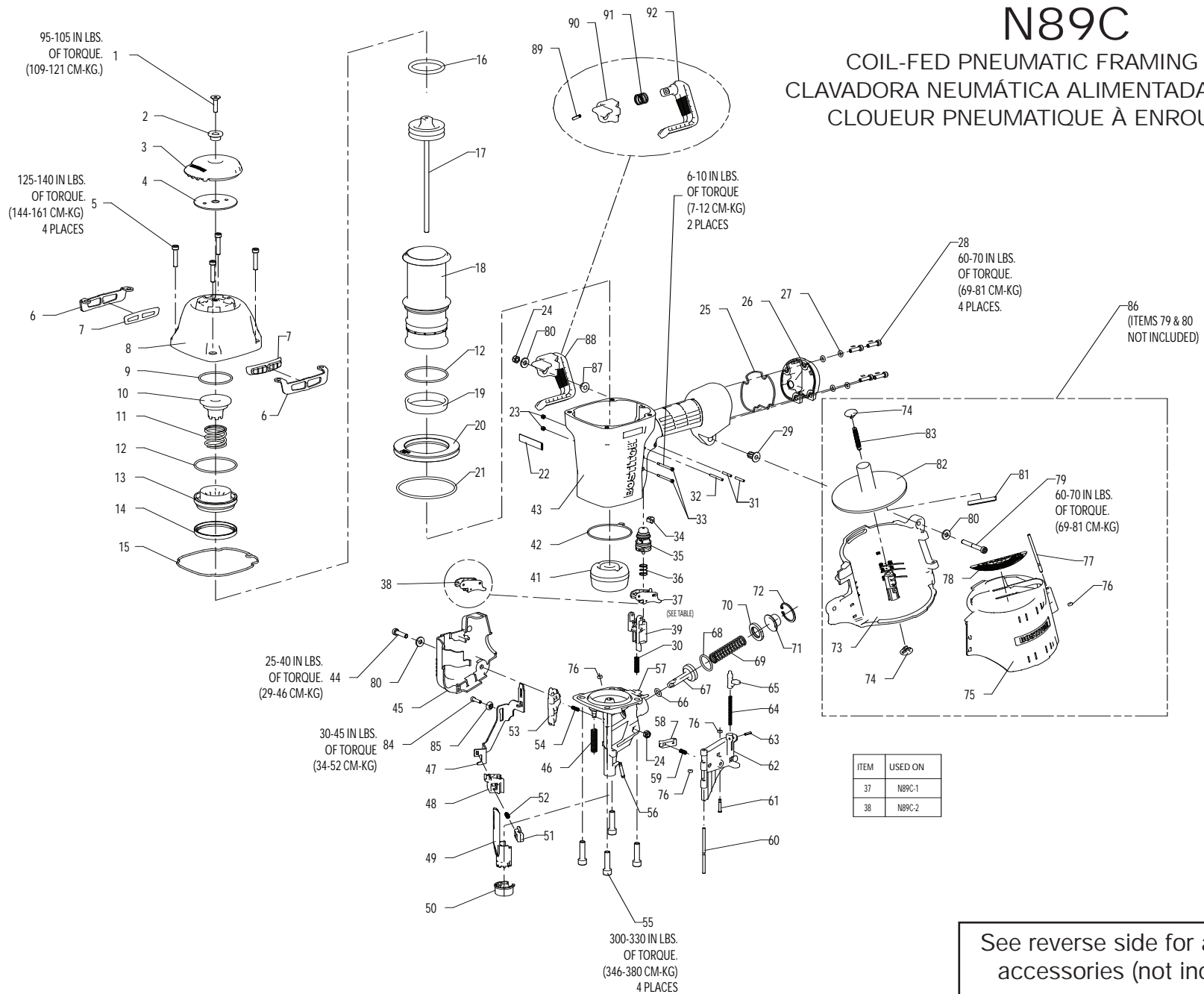

See reverse side for available accessories (not included)

## BOSTITCH

N89C		Parts List:		IP1219-2REVG	
<b>To be Used with tool parts illustration:</b>					
<b>and operation and maintenance manual:</b>					
<b>Serial Number on the Tool:</b>					
<b>N89C 7010 000 and Higher</b>					
ITEM	PART #	DESCRIPTION	ITEM	PART #	DESCRIPTION
1	MSF6100-25	SCREW,SFHCS,M6X1.00X25	55	MSC8125-30	SCREW,SHCS M8X30
2	163859	BUSHING,EXHAUST DEFLECTOR	56	166787	PIN,FEED PAWL
3	163818	DEFLECTOR,EXHAUST	57	166763	NOSE,MACHINING,N89C
4	163830	PLATE,CAP	58	N70149	PAWL CHECK
5	MSC6100-30	SCREW,SHCS,M6X1.00X30	59	854011	COMPRESSION SPRING
6	163827	PLATE,WEAR	60	N80125	PIN,SPECIAL
7	149819	WEAR GUIDE	61	N70140	PIN,SPECIAL(STEP)
8	163848	FRAME CAP,MACHINING	62	166760	DOOR,MACHINING,N89C
9	105814	O-RING,1.929X.098	63	MPG030012	PIN,SPRING,M3X12MM
10	163820	BUMPER,HEAD VALVE	64	854013	SPRING,COMPRESSION
11	163844	SPRING,HEAD VALVE	65	N70150	LATCH DOOR
12	163822	O-RING,2.487X.103XNBR	66	88999	O-RING,.362X.103
13	163821	LOWER BODY,HEAD VALVE	67	163894	O-RING,.924X.103
14	163823	SEAL,HEAD VALVE	68	87112	SPRING,FEED PISTON
15	163845	SEAL,FRAME/CAP	69	163930	STOP,FEED PISTON
16	851606	O-RING,1.850X.210	70	163897	COLLAR,SPRING
17	163816	ASSEMBLY,PISTON/DRIVER	71	163895	RETAINING RING,INCH
18	163824	SLEEVE,CYLINDER	72	163896	PLATFORM,CANISTER,N89C
19	175520	SEAL,CHECK	73	163892	CAP,NAIL TRAY
20	163855	RING,CYLINDER SLEEVE	74	149910	COVER,CANISTER,N89C
21	108718	O-RING,3.484X.139	75	163910	WASHER,RUBBER-7
22	163881	LABEL,N89C	76	854004	PIN,CANISTER COVER
23	MHE3050-100	NUT,NYLON M3X.50	77	166771	LABEL,WARNING,PALLET
24	MHE6100-100	NUT,ESN M6X1	78	165358	SCREW,SHSC,M6X1.00X50
25	163856	SEAL,END CAP	79	MSC6100-50	WASHER.SPECIAL
26	163843	END CAP,PAINT	80	MPW6.2	LABEL,SENSOR SMALL (DR)
27	T50118	WASHER,PLAIN	81	120927	TRAY,CANISTER,N89C
28	MSC5080-20	SCREW,SOC HD. CAP M5 X 20	82	163893	SPRING,EXTENSION - CANISTER
29	123859	BUSHING,FLANGED ISOLATION	83	166768	SCREW,SHCS,M4X0.7X16
30	166781	SPRING,UPPER TRIP	84	MSC4070-16	BUSHING,UPPER CONTACT ARM
31	MPP030020	PIN,SPIRAL M3X20MM	85	163876	ASSEMBLY,CANISTER
32	100298	PIN,SPIRAL M3X30	86	166807	WASHER,UTILITY HOOK
33	108562	SCREW,TRIGGER PIVOT	87	171342	ASSEMBLY,UTILITY HOOK
34	164225	ACTUATOR,SMARTTRIGGER	88	171354	PIN, SPIROL - 5/32X3/4
35	TVA6	KIT,TRIGGER VALVE	89	UB3811.2	MOUNT,UTILITY HOOK
36	100387	SPRING,COMPRESSION	90	171340	SPRING,UTILITY HOOK
37	CNTK4	KIT,CONTACT TRIP CONVERSION	91	171341	HOOK,UTILITY
38	SEQ7	KIT,SEQUENTIAL TRIP CONVERSION	92	171339	
39	163883	GUIDE,ARM			
41	107231	BUMPER,DRIVE			
42	163884	SEAL,NOSE			
43	171127	FRAME,OVERMOLD			
44	MSC6100-25	SCREW,SHCS,M6X1.00X25			
45	166766	COVER,TRIP			
46	116970	SPRING,CONTACT ARM			
47	163908	ARM,UPPER CONTACT			
48	163906	CASTING,HOUSING CONTACT			
49	163907	ARM,LOWER CONTACT			
50	166765	FOOT,TRIP,N89C			
51	108225	CASTING,PLUNGER			
52	115230	SPRING,HOUSING			
53	166773	PAWL,FEED,MACHINING,N89C			
54	166774	SPRING,FEED PAWL			